

DRYWALL FLOATING CEILING

with integrated capillary tube mat (OPTIPANEL 15/OPTIPANEL 18) or
with capillary tube mat ORIMAT S 10/G 10 applied on site on the canopy



System data sheet



SHK INNUNG BERLIN © CLINA HEIZ- UND KÜHLELEMENTE GMBH

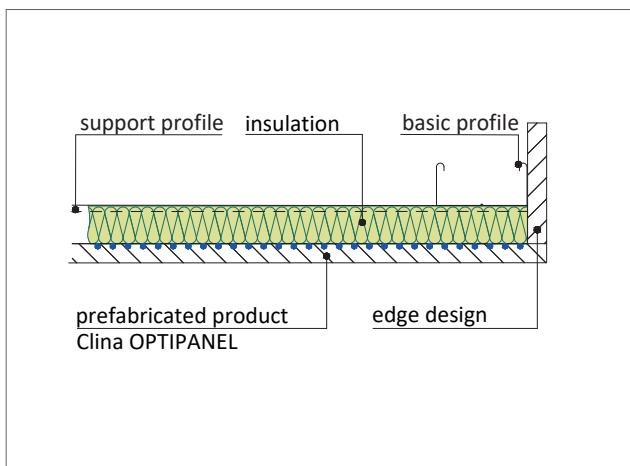

gypsum board canopy with **integrated** capillary tube mat

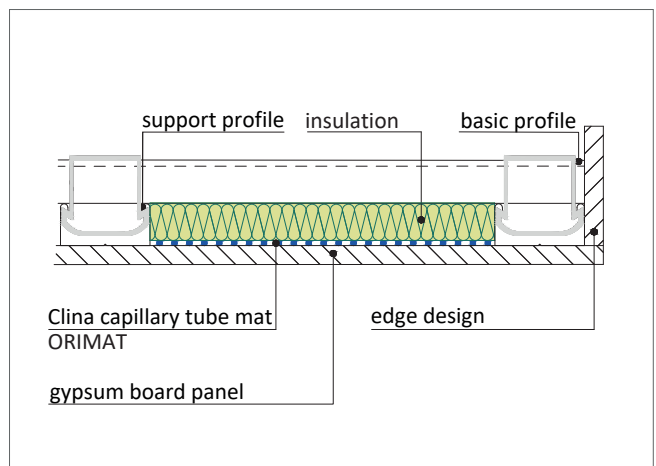

gypsum board canopy with capillary tube mat **applied on site**

CLINA - BETTER HEATING AND COOLING

DRYWALL FLOATING CEILING



with integrated capillary tube mat (OPTIPANEL 15/OPTIPANEL 18) or
with capillary tube mat ORIMAT S 10/G 10 applied on site



System data sheet

DESCRIPTION	ADVANTAGES
<ul style="list-style-type: none"> ▪ Clina gypsum board canopies are available in two versions: <ul style="list-style-type: none"> ▫ with integrated capillary tube mat/OPTIPANEL prefabricated product (see Product data sheet OPTIPANEL 15/18) ▫ with capillary tube mat applied on site/ORIMAT S10 the capillary tube mats manufactured according to the dimensions of the canopy are fixed between the profiles of the substructure of the canopy, if required insulation material is placed on top ▪ the edge design of both versions is made with drywall mouldings ▪ the connections of the capillary tube mats or canopies to each other as well as the connection to the supply and return lines/ceiling sub-distributors are usually made on site using a proven push-lock system with flexible hoses (OPTIPANEL) or by heating element socket welding (ORIMAT S 10) ▪ the leak test according to factory guidelines is carried out after the installation of the canopies 	<p>OPTIMIZED ROOM COMFORT Gypsum board canopies noticeably and efficiently improve room comfort both thermally and acoustically.</p> <p>GOOD ACOUSTICS - PERFORATED VERSION The capillary tube mat does not require any heat-conducting profiles that would cover the perforation and thus reflect the sound. The open construction helps to improve the acoustics in the room. The sound absorption values of the drywall canopies specified by the manufacturers are maintained without restriction.</p> <p>EASY RETROFITTING Clina capillary tube mats turn any drywall floating ceiling into a heating and cooling floating ceiling, quickly and economically.</p> <p>MAXIMUM DEGREE OF ACTIVATION The dimensions of the capillary tube mat are individually adapted to the size of the canopies.</p>

TECHNICAL DATA

 <p>HEATING CAPACITY according to DIN EN 14037/2</p> <p>depending on the design</p>	 <p>COOLING CAPACITY according to DIN EN 14240</p> <p>depending on the design</p>	 <p>ACOUSTICS (applies only to perforated version)</p> <p>weighted sound absorption coefficient as specified by the manufacturer of the drywall canopies</p>
---	---	--

INSTALLATION HEIGHT (depending on substructure):
mat **applied on site** depends on canopy + substructure
integrated mat **12,5 mm** + substructure

SYSTEM WEIGHT (filled with water):
mat **applied on site** **1 kg/m²** plus canopy + substructure + insulation
integrated mat **11 kg/m²** or **9 kg/m²** plus substructure + insulation

Component	Material	Dimensions	Other
CAPILLARY TUBE MAT	polypropylene (PP-R), recyclable	mat distributor pipe: 20 x 2,0 mm capillary tube mat: 4,3 x 0,8 mm (OPTIPANEL) or 3,4 x 0,55 mm (ORIMAT) distance of the capillaries: 10/15/18 mm length & width: acc. to the canopy dimensions	designation: OPTIPANEL GB 15/GB 18 or ORIMAT S 10/G 10 weight (incl. water): approx. 1 kg/m ² pressure stage: PN 10
GYPSUM BOARD PANEL	gypsum, cardboard, possibly graphite perforated/unperforated	panel thickness: 12,5 mm/10 mm	edge design: drywall mouldings
INSULATION (if required)	mineral wool or equivalent		preferably shrink-wrapped in foil
PUSH-LOCK CONNECTION	polypropylene (PP-R), recyclable brass, partially nickel-plated	push-lock system: 10 mm	O-ring sealing
CONNECTING HOSE	inside: rubber (EPDM) outside: high pressure nylon fabric connector: nickel-plated brass	lengths: 500/800/1200/5000 mm diameter hose: DN 10 outside diameter connector: 10 mm	flexible, pressure stage: PN 10 push-lock system
SUPPLY AND RETURN LINES	polypropylene (PP-R), recyclable	depending on the room size	can be delivered prefabricated

CONTACT

Clina Heiz- und Kühlelemente GmbH
Eichhorster Weg 80 | 13435 Berlin

Fon: + 49 30 402054 – 0
Fax: + 49 30 402054 – 19

www.clina.de
info@clina.de