

JOINTLESS DRYWALL CEILING

with capillary tube mat ORIMAT S 10 applied on site

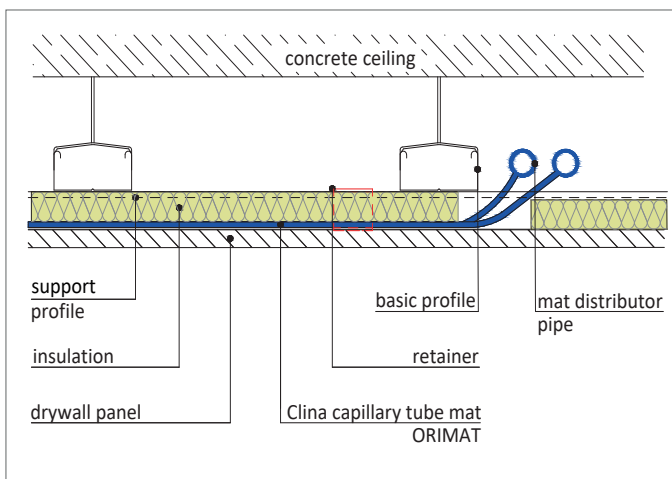

System data sheet



CLINA - BETTER HEATING AND COOLING

JOINTLESS DRYWALL CEILING

with capillary tube mat ORIMAT S 10 applied on site



DESCRIPTION

- custom-made capillary tube mats are fixed between the profiles of the substructure of the drywall ceiling and an insulation is applied
- mat distributor pipes and supply lines are placed in the void of the suspended ceiling
- the hydraulic connection to the supply and return lines is made either by heating element socket welding or by a proven push-lock system with flexible hoses
- before the ceiling is closed, the leak test is carried out according to the factory guideline
- after the leak test, the ceiling is closed with perforated or unperforated drywall panels

ADVANTAGES

HIGH DEGREE OF FLEXIBILITY

Changes in the ceiling mirror and small cut-outs < Ø 100 mm can still be realised during installation.

EASY SEPARATION OF THE WORKS

A contractual and temporal separation of the sub-works system construction and dry construction is possible.

EASY RETROFITTING

Can be mounted on an existing substructure.
The hydraulic connection is located in the ceiling void.

GOOD ACOUSTICS

The acoustic values of the panel manufacturers remain unchanged.

TECHNICAL DATA



HEATING CAPACITY

according to DIN EN 14037/5

up to **85,8 W/m²**

(unperforated thermoboard 10 mm)

ΔT = 15 K, active mat surface

up to **85,8 W/m²**

(perforated gypsum board panel

12,5 mm)

ΔT = 15 K, active mat surface



COOLING CAPACITY

according to DIN EN 14240

up to **66,9 W/m²**

(unperforated thermoboard 10 mm)

ΔT = 10 K, active mat surface

up to **64,9 W/m²**

(perforated gypsum board panel

12,5 mm)

ΔT = 10 K, active mat surface



ACOUSTICS

(only applies to perforated version)

weighted sound absorption coefficient

up to **α_w = 0,7** (Class C)

INSTALLATION HEIGHT:

depending on substructure & on drywall material
Suspension height of the drywall ceiling > **10 cm**

SYSTEM WEIGHT (filled with water):

740 g/m² plus drywall ceiling

Component	Material	Dimensions	Other
CAPILLARY TUBE MAT	polypropylene (PP-R), recyclable	mat distributor pipe: 20 x 2,0 mm capillary tube: 3,4 x 0,55 mm distance of the capillaries: 10 mm length: 600-6000 mm width: according to distance between substructure	designation: ORIMAT S 10.00/G 10.00 weight (incl. water): approx. 740 g/m ² open mat distributor pipes pressure stage: PN 10
DRYWALL PANEL	gypsum, cardboard, possibly graphite perforated/unperforated	as specified by the manufacturer	drywall panels of different manufacturer freely selectable
INSULATION	mineral wool or equivalent	height: 30 mm	preferably shrink-wrapped in foil
FLOW AND RETURN LINES	polypropylene (PP-R), recyclable	depending on room size	connection alternating according to Tichelmann principle

CONTACT

Clina Heiz- und Kühlelemente GmbH
Eichhorster Weg 80 | 13435 Berlin

Fon: + 49 30 402054 – 0
Fax: + 49 30 402054 – 19

www.clina.de
info@clina.de